



INSTRUCTION MANUAL

8" Bench Grinder

Item# 6318-06

Model # TBG818







PLEASE READ AND SAVE ALL INSTRUCTIONS TO ENSURE THE SAFE AND EFFECTIVE USE OF THIS TOOL

TABLE OF CONTENTS

Table of Contents	P.1
Important Safeguards	P. 2-4
Rules for Safe Operation	P.5
General Safety Rules	P.6,7
Contents of Packaging	P.8
List of Main Parts, Technical Specifications	P.9
Features	P. 10
Assembly	P.10-12
Operation	P.13-14
Maintenance	P.14-15
Warranty Information	P.16
Warranty Card	P.17

The purpose of safety symbols is to attract your attention to possible dangers. The safety symbols, and the explanations with them, deserve your careful attention and understanding. The safety warnings do not by themselves eliminate any danger. The instructions or warnings they give are not substitutes for proper accident prevention measures.

SYMBOL	MEANING
	SAFETY ALERT SYMBOL: Indicates danger, warning, or caution. May be used in conjunction with other symbols or pictographs.
	DANGER: Failure to obey a safety warning will result in serious injury to you or to others. Always follow the safety precautions to reduce the risk of fire, electric shock and personal injury.
	WARNING: Failure to obey a safety warning can result in serious injury to you or to others. Always follow the safety precautions to reduce the risk of fire, electric shock and personal injury.
	CAUTION: Failure to obey a safety warning may result in property damage or personal injury to you or to others. Always follow the safety precautions to reduce the risk of fire, electric shock and personal injury.

When you see “**NOTE:**” this advises you of information or instructions vital to the operation or maintenance of the equipment.



IMPORTANT SAFEGUARDS

PLEASE READ THESE INSTRUCTIONS CAREFULLY TO ENSURE THE SAFE AND EFFECTIVE USE OF THIS TOOL.

Safe operation of this power tool requires that you read and understand this operator's manual and all labels affixed to the tool. Safety is a combination of common sense, staying alert, and knowing how your bench grinder works.

READ AND SAVE ALL INSTRUCTIONS

- **KNOW YOUR POWER TOOL.** Read the operator's manual carefully. Learn the applications and limitations as well as specific potential hazards related to this tool.
- **GUARD AGAINST ELECTRICAL SHOCK** by preventing body contact with grounded surfaces. For example: pipes, radiators, ranges, refrigerator enclosures.
- **KEEP GUARDS IN PLACE** and in working order. Never operate the tool with any guard or cover removed. Make sure all guards are operating properly before each use.
- **REMOVE ADJUSTING KEYS AND WRENCHES.** Form habit of checking to see keys and adjusting wrenches are removed from tool before turning it on.
- **KEEP THE WORK AREA CLEAN.** Cluttered work areas and work benches invite accidents.
- **AVOID DANGEROUS ENVIRONMENTS.** Do not use power tools near gasoline or other flammable liquids, in damp or wet locations or expose them to rain. Keep work area well lighted.
- **KEEP CHILDREN AND VISITORS AWAY.** All visitors should wear safety glasses and be kept a safe distance from work area.
- **MAKE WORKSHOP CHILDPROOF** with padlocks, master switches, or by removing starter keys.
- **DON'T FORCE THE TOOL.** It will do the job better and safer at the rate for which it was designed.
- **USE THE RIGHT TOOL.** Do not force the tool or attachment to do a job for which it was not designed.
- **USE THE PROPER EXTENSION CORD.** Make sure your extension cord is in good condition. When using an extension cord, be sure to use one heavy enough to carry the current your product will draw. An undersized cord will cause a drop in line voltage resulting in loss of power and overheating. A wire gage size (A.W.G.) of at least **16** is recommended for an extension cord 25 feet or less in length. If in doubt, use the next heavier gage. The smaller the gage number, the heavier the cord.
- **INSPECT EXTENSION CORDS PERIODICALLY** and replace if damaged.
- **WEAR PROPER APPAREL.** Do not wear loose clothing, neckties, or jewelry that can get caught in the tool's moving parts and cause personal injury. Non-slip footwear is recommended when working outdoors. Wear protective hair covering to contain long hair.
- **ALWAYS WEAR SAFETY GLASSES WITH SIDE SHIELDS.** Everyday eyeglasses have only impact resistant lenses; they are NOT safety glasses.
- **PROTECT YOUR LUNGS.** Wear a face or dust mask if the grinding operation is dusty.
- **PROTECT YOUR HEARING.** Wear hearing protection during extended periods of operation.
- **DON'T ABUSE CORD.** Never carry tool by the cord or yank it to disconnect from receptacle. Keep cord from heat, oil, and sharp edges.
- **DO NOT OVERREACH.** Keep proper footing and balance at all times.

SAVE THESE INSTRUCTIONS

- **MAINTAIN TOOLS WITH CARE.** Keep tools sharp and clean for best and safest performance. Follow instructions for light bulbs and grinding wheel.
- **NEVER LEAVE TOOL RUNNING UNATTENDED. TURN POWER OFF.** Disconnect all tools when not in use, before servicing, or when changing attachments, wheels, etc.
- **AVOID ACCIDENTAL STARTING.** Be sure switch is off when plugging in.
- **USE RECOMMENDED ACCESSORIES.** The use of improper accessories may cause risk of injury.
- **USE ONLY GRINDING WHEELS** that comply with ANSI B7.1 and rated greater than 3600 RPM.
- **DO NOT** use wheels with incorrect size holes. NEVER use wheel washers or wheel screws that are defective or incorrect and NEVER touch grinding wheel or other moving parts.
- **NEVER STAND ON TOOL.** Serious injury could occur if the tool is tipped or if the wheel is unintentionally contacted.
- **DIRECTION OF FEED.** Be aware of wheel rotation direction; never grind without the work rest being properly set. NEVER grind more than one work piece at a time.



WARNING: Wheel coasts after being turned off.

- **CHECK DAMAGED PARTS.** Before further use of the tool, a guard or other part that is damaged should be carefully checked to determine that it will operate properly and perform its intended function. Check for alignment of moving parts, binding of moving parts, breakage of parts, mounting and any other conditions that may affect its operation. A guard or other part that is damaged must be properly repaired or replaced by an authorized service center to avoid risk of personal injury.
- **KEEP TOOL DRY, CLEAN, AND FREE FROM OIL AND GREASE.** Always use a clean cloth when cleaning. Never use brake fluids, gasoline, petroleum-based products, or any solvents to clean tool.
- **INSPECT TOOL CORDS AND EXTENSION CORDS PERIODICALLY** and, if damaged, have repaired by a qualified service technician. Stay constantly aware of cord location and keep it well away from the rotating wheel.
- **NEVER USE IN AN EXPLOSIVE ATMOSPHERE.** Normal sparking of the motor or sparking from grinding metal could ignite fumes.
- **USE OUTDOOR EXTENSION CORDS.** Use only extension cords with approved ground connection that are intended for use outdoors and so marked.
- **RISK OF INJURY DUE TO ACCIDENTAL STARTING** Do not use in an area where children may be present.
- **NEVER START THE GRINDER** when the wheel is in contact with the work piece.
- **SECURE WORK.** Always hold work piece firmly against the work rest.
- **DO NOT USE THE BENCH GRINDER** if the flange nut or clamp nut is missing or if the spindle shaft is bent.
- **FREQUENTLY** clean grinding dust from beneath grinder.
- **DO NOT OPERATE THIS TOOL WHILE UNDER THE INFLUENCE OF DRUGS, ALCOHOL, OR ANY MEDICATION.**
- **ALWAYS STAY ALERT.** Do not allow familiarity, gained from frequent use of your grinder, to cause a careless mistake. **ALWAYS REMEMBER** that a careless fraction of a second is sufficient to inflict severe injury.
- **STAY ALERT AND EXERCISE CONTROL.** Watch what you are doing and use common sense. Do not operate tool when you are tired. Do not rush.
- **SAVE THESE INSTRUCTIONS.** Refer to them frequently and use them to instruct other users. If you loan someone this tool, loan them these instructions also.

SAVE THESE INSTRUCTIONS

- **NEVER** reach to pick up a work piece, a piece of scrap, or anything else that is in or near the grinding path of the wheel.
- **AVOID AWKWARD OPERATIONS AND HAND POSITIONS** where a sudden slip could cause your hand to move into the wheel. **ALWAYS** make sure you have good balance.
- **NEVER** stand or have any part of your body in line with the path of the wheel.
- **DO NOT USE TOOL IF SWITCH DOES NOT TURN IT ON AND OFF.** Have defective switches replaced by an authorized service center.
- **DO NOT TURN THE MOTOR SWITCH ON AND OFF RAPIDLY.** This could cause the wheel to loosen and could create a hazard. Should this ever occur, stand clear and allow the wheel to come to a complete stop. Disconnect your grinder from the power supply and securely retighten the wheel nut.



WARNING: When servicing use only identical replacement parts. Use of any other parts may create a hazard or cause product damage.

- **USE ONLY FLANGES** furnished with this bench grinder.
- **IF ANY PART OF THIS GRINDER IS MISSING** or should break, bend, or fail in any way, or should any electrical component fail to perform properly, shut off the power switch, remove the machine plug from the power source and have damaged, missing, or failed parts replaced before resuming operation.
- **MAKE SURE THE GRINDER IS SECURELY MOUNTED** as described in the operating instructions before connecting the tool to a power supply.
- **DO NOT OVERTIGHTEN THE WHEEL NUT.** Excessive tightening can cause the wheel to crack during operation.
- **INSPECT GRINDING WHEEL** for visible defects. Check the wheel for cracks. Replace defective wheels prior to use.
- **ADJUST** distance between wheel and work rest to maintain 1/16 in. or less separation, re-adjustment is necessary as the diameter of the wheel decreases with use.
- **ALWAYS EASE THE WORKPIECE AGAINST THE ABRASIVE WHEEL** when starting to grind. A harsh impact can break the wheel. Use light pressure when starting to grind; too much pressure on a cold wheel can cause the wheel to crack.

SAVE THESE INSTRUCTIONS



SAVE THESE INSTRUCTIONS

WARNING:

Some dust created by power sanding, sawing, grinding, drilling, and other construction activities contains chemicals known to cause cancer, birth defects or other reproductive harm. Some examples of these chemicals are:

- Lead from lead-based paints,
- Crystalline silica from bricks and cement and other masonry products, and
- Arsenic and chromium from chemically-treated lumber.

Your risk from these exposures varies, depending on how often you do this type of work. To reduce your exposure to these chemicals, work in a well ventilated area, and work with approved safety equipment, such as those dust masks that are specially designed to filter out microscopic particles

WARNING:

IMPORTANT

Servicing requires extreme care and knowledge and should be performed only by a qualified service technician.

WARNING:

Do not attempt to operate this tool until you have read thoroughly and understand completely all instructions, safety rules, etc. contained in this manual. Failure to comply can result in accidents involving fire, electric shock, or serious personal injury. Save this operator's manual and review frequently for continuing safe operation and instructing others who may use this tool.

The operation of any power tool can result in foreign objects being thrown into your eyes, which can result in severe eye damage. Before beginning tool operation, always wear safety goggles or safety glasses with side shields and a full face shield when needed. We recommend Wide Vision Safety Mask for use over eyeglasses or standard safety glasses with side shields. Always wear eye protection which is marked to comply with ANSI Z87.1.

CAUTION: Failure to obey a safety warning may result in property damage or personal injury to you or to others. Always follow the safety precautions to reduce the risk of fire, electric shock and personal injury.

SAVE THESE INSTRUCTIONS!

GENERAL SAFETY RULES

WARNING! Read, understand and save all instructions. Failure to follow all instructions listed below may result in electric shock, fire or serious personal injury. The warnings, cautions, and instructions discussed in this instruction manual cannot cover all possible conditions and situations that may occur. It must be understood by the operator that common sense and caution are a factor which cannot be built into this product, but must be supplied by the operator.

READ AND SAVE ALL INSTRUCTIONS!

WORK AREA

1. Keep your work area clean and well organized. Cluttered benches and dark areas invite accidents.
2. Do not operate power tools in explosive atmospheres, such as in the presence of flammable liquids, gases, or dust. Power tools create sparks which may ignite the dust or fumes.
3. Keep bystanders, children and visitors away while operating a power tool. Distractions can cause you to lose control.

ELECTRICAL SAFETY

1. Do not abuse the cord. Never use the cord to carry the tool. Keep cord away from heat, oil, sharp edges or moving parts. Replace damaged cords immediately. Damaged cords may create a risk of fire.
2. The use of any Extension Cord will cause some loss in the voltage. This will result in a loss of power and overheating. To keep it at a minimum, and to prevent the motor from burning out, avoid using an extension cord. If an extension cord must be used, it must be no longer than 25 feet with a minimum wire size not less than 12 AWG.
3. This tool has a three wire grounding plug. Under no circumstances shall a temporary adapter be used, or alterations be made to the plug.

PERSONAL SAFETY

1. Stay alert, watch what you are doing and use common sense when operating a power tool. Do not use tool while tired or under the influence of drugs, alcohol or medication. A moment of inattention while operating power tools may result in serious personal injury.
2. Dress properly. Do not wear loose clothing or jewelry. Contain long hair. Keep your hair, clothing and gloves away from moving parts. Wear protective goggles when operating the machine. It is recommended to wear protective goggles, gloves, sturdy non-slipping shoes and an apron.
3. Avoid accidental starting. Be sure switch is in OFF position before connecting to a power outlet. Carrying tools with your finger on the switch when the switch is ON invites accidents. Disconnect tool from power outlet before carrying out any work on the machine.
4. Remove adjusting wrench before turning the tool on. A wrench or a key that is left attached to a rotating part of the tool may result in personal injury
5. Do not overreach. Keep proper footing and balance at all times. Proper footing and balance enables better control of the tool in unexpected situations.
6. Use safety equipment. Always wear eye protection. Dust mask, non-skid safety shoes, hard hat, or hearing protection must be used for appropriate conditions.



TOOL USE AND CARE

1. Use clamps or other practical way to secure and support the work piece to a stable platform. Holding the work by hand or against your body is unstable and may lead to loss of control.
2. Do not force tool. Use the correct tool for your application. The correct tool will do the job better and safer at the rate for which it is designed.
3. Do not use tool if switch does not turn ON or OFF. Any tool that cannot be controlled with a switch is dangerous and must be repaired.
4. Place the switch in locked or OFF position before making any adjustments, changing accessories or storing the tool. Such preventive safety measures reduce the risk of starting the tool accidentally.
5. Store idle tools out of reach of children and other untrained persons. Tools are dangerous in the hands of untrained users. They should be kept away from work area.
6. Maintain tools with care. Keep cutting tools sharp and clean. Properly maintained tools, with sharp cutting edges are less likely to bind and are easier to control.
7. Check for misalignment or binding of moving parts, breakage of parts and any other condition that may affect the tools operation. If damaged, have the tool serviced before using. Many accidents are caused by poorly maintained tools.
8. Use only accessories that are recommended by the manufacturer for your model. Accessories that may be suitable for one tool may become hazardous when used on another tool.

SERVICE

1. Tool service must be performed only by qualified repair personnel. Service or maintenance performed by unqualified personnel could result in a risk of injury.
2. When servicing a tool, use only identical replacement parts. Follow instructions in the maintenance section of this manual. Use of unauthorized parts or failure to follow Maintenance Instructions may create a risk of electric shock or injury.

SAVE THESE INSTRUCTIONS!

CONTENTS OF PACKAGING

WARNING: If any parts are missing, do not operate this tool until the missing parts are replaced. Failure to do so could result in possible serious personal injury.

Note: If any parts are damaged or missing, do not attempt to plug in the power cord and turn the switch on until the damaged or missing parts are obtained and are installed correctly.

WARNING: To prevent accidental starting or electrical shock that could cause possible serious personal injury, assemble all parts to your bench grinder before connecting it to power supply. The bench grinder should never be connected to power supply when you are assembling parts, making adjustments, lubricating, installing or removing grinding wheels, cleaning, or when not in use.

Carefully remove all parts from the shipping carton.

- Lift the bench grinder from the carton and place it on a level work surface.
- Do not discard the packing materials until you have carefully inspected the machine, identified all loose parts, and satisfactorily operated your bench grinder.
- Examine all parts to make sure no breakage or damage has occurred during shipping.
- If all parts have been included, proceed to assembly.
- If any parts are damaged or missing, do not attempt to assemble.

Check all loose parts from the box with the list below. Assemble according to the instructions on the following pages.

- a. Safety Shield Support Bar x 2
- b. Safety Shield Support Fixing Knob x 2 (yellow thumbscrews)
- c. Safety Shield
- d. Magnifying Safety Shield
- e. Work Rest Support x 2 (left and right)
- f. Spark Deflectors (should be attached to grinder) x 2
- g. Work Rest Fixing Knobs x 2 (yellow thumbscrews)
- h. Washer x 4
- i. Lock Washer x 2
- j. Instruction Manual

If any of the above items are missing, please contact our service department at 1-888-367-7373 (<http://www.wk-usa.com>) for replacement.

TOOLS NEEDED

The following tools (not included) are needed for assembly and alignment:

- **COMBINATION WRENCH**
- **PHILLIPS SCREWDRIVER**
- **ADJUSTABLE WRENCH**

These tools can be purchased from any local hardware store.

LIST OF MAIN PARTS

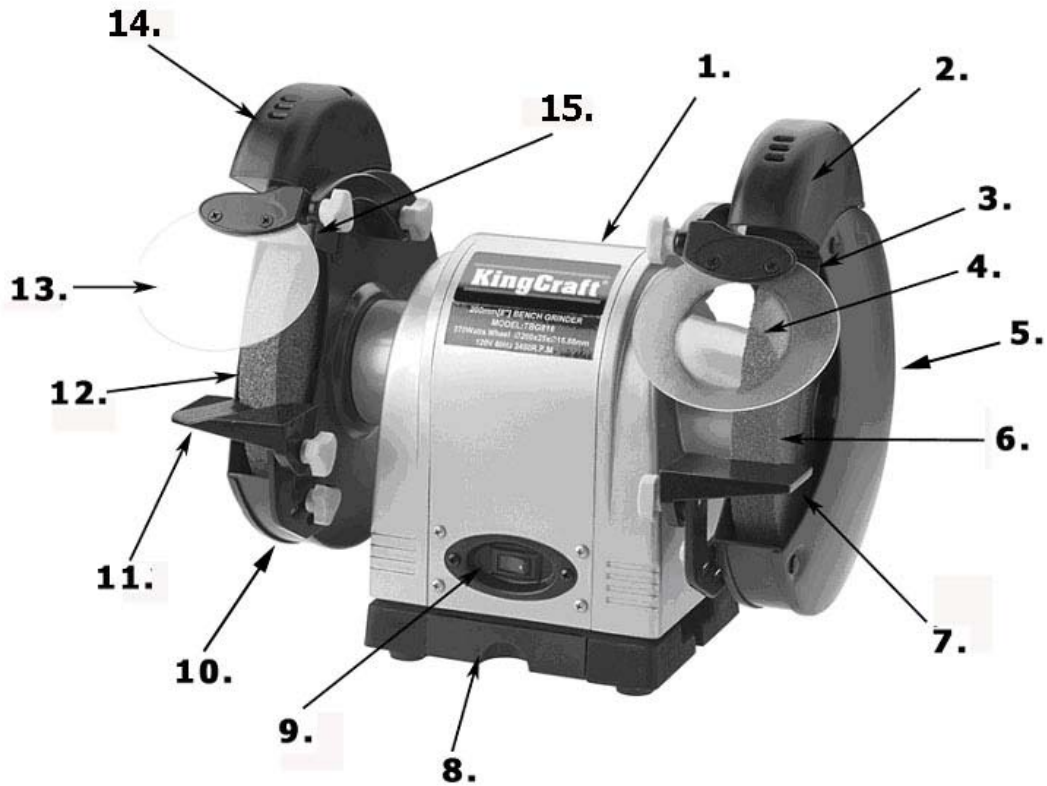

- | | |
|---------------------------------------|-----------------------------|
| 1. Motor | 9. ON/OFF Switch |
| 2. Auto ON Work Light Right | 10. Wheel Guard Left |
| 3. Spark Deflector Right | 11. Work Rest Left |
| 4. Safety Shield Right with Magnifier | 12. Grinding Wheel Left |
| 5. Wheel Guard Right | 13. Safety Shield Left |
| 6. Grinding Wheel Right | 14. Auto ON Work Light Left |
| 7. Work Rest Right | 15. Spark Deflector Left |
| 8. Coolant Tray | |

TECHNICAL SPECIFICATIONS:

Item Number	6318-06	Wheels	
Model Number	TBG818	Diameter	8"
Rating Voltage	120 Vac	Thickness	1"
Frequency	60Hz	Arbor Hole	5/8 in.
Amperes	3.0	Work Light	
No Load Speed	3600 RPM	Rating Voltage	12 V
Weight	48 ½ lbs	Watt	10W

FEATURES

KNOW YOUR BENCH GRINDER

Before attempting to use your new tool, familiarize yourself with all operating features and safety requirements. Carefully read this operator's manual before using your grinder.

ON/OFF SWITCH

Your Bench Grinder features a front access On/Off switch for convenience and safety.

MOTOR

Powered by a precision-built electric induction motor, your bench grinder has sufficient power to handle tough grinding jobs.

GRINDING WHEEL

Equipped with coarse grinding wheels to suit most applications.

Note: New wheels can be purchased from your local hardware store.

SAFETY SHIELD AND SPARK DEFLECTOR

The safety shields and spark deflectors are adjustable for operator convenience. Operating the grinder without these features attached could result in serious injury. **Do not** grind with the safety shield raised; always wear safety glasses for personal protection.

WORK REST

The work rests are independently adjustable to compensate for wheel wear. Before grinding, make certain the work rests are adjusted properly. Generally the object being ground is done slightly above center of the grinding wheel. Adjust the distance between the wheel and the work rest to maintain 1/16 in. (1.6 mm) or less separation as the diameter of the wheel decreases with use.

AUTO-ON WORKLIGHT

Your Bench Grinder comes equipped with permanently mounted work lights that automatically lights the work area for safer, more accurate grinding and sharpening.

COOLING TRAY

When grinding, metal objects become heated quickly. It is important to keep moving the object back and forth across the grinding wheel and to cool the object frequently using the grinder's Cooling Tray.

ASSEMBLY

WARNING: Always disconnect the bench grinder from the power source before performing any assembly or adjustment. Failure to do so could result in accidental starting resulting in possible serious personal injury.

SPARK DEFLECTOR

Spark Deflector is attached to the Bench Grinder.

If necessary, adjust the spark deflectors to within 1/16 in. (1.6 mm) of the grinding wheel. Tighten screws securely.

WARNING: Always spin the wheel by hand before turning on the grinder to make sure the spark deflector doesn't hit the grinding wheel.



SHIELD BRACKET ASSEMBLY

Note: The hardware used for assembling the safety shields to the shield brackets has been preassembled and prepackaged.

Attach safety shield support bar to grinder with a thumb screw.



WARNING: Excessive pressure on a cold wheel may cause the wheel to crack.

MOUNTING SAFETY SHIELDS

Take Shield Bracket and attach onto safety shield support bar with thumb screws.

Refer to illustration on page 5 to determine left and right safety shields.



WARNING: To prevent personal injury, never operate the bench grinder unless the safety shields and spark deflectors are properly installed and in place.

WORK REST

Before attempting to mount the work rest, remove the pre-attached thumb screw with hex bolt and star washer. Place the work rest over the hex bolt before replacing the thumb screw and star washer. Using the thumb screw and star washer, secure the work rest against the inside of the wheel guard.

Before tightening the thumb screw, adjust the gap between the grinding wheel and the work rest to a maximum of 1/16 in. (1.6 mm). Tighten securely.

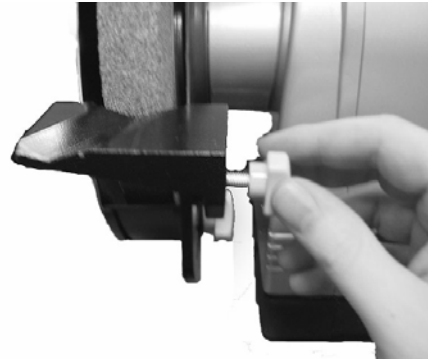

WARNING: Always make sure your bench grinder is securely mounted to a workbench or an approved work stand. Failure to do so could result in an accident resulting in possible serious personal injury.

MOUNTING TO WORKBENCH

If your bench grinder is to be used in a permanent location, it is recommended you secure it to a workbench or other stable surface. When mounting the bench grinder to a workbench, holes should be drilled through the supporting surface of the workbench.

- Mark holes on workbench where bench grinder is to be mounted using holes in the base as a template for hole pattern.
- Drill holes through workbench.
- Place bench grinder on workbench aligning holes in the base with holes drilled in the workbench.
- Insert bolts (not included) and tighten securely with lock washers and hex nuts (not included).

Note: All bolts should be inserted from the top. Install the lock washers and hex nuts from the underside of the workbench.

CLAMPING TO WORKBENCH

If your bench grinder is to be used as a portable tool, it is recommended you fasten it permanently to a mounting board that can easily be clamped to a workbench or other stable surface. The mounting board should be of sufficient size to avoid tipping while bench grinder is in use. Any good grade plywood or chipboard with a 3/4 in. (19 mm) thickness is recommended.

- Mark holes on board where bench grinder is to be mounted using holes in the base as a template for hole pattern.
- Follow last three steps in section Mounting to Workbench.

If lag bolts are used, make sure they are long enough to go through holes in bench grinder base and material the bench grinder is being mounted to. If machine bolts are used, make sure bolts are long enough to go through holes in bench grinder, the material being mounted to, and the lock washers and hex nuts.

OPERATION

WARNING: Do not attempt to operate this tool until you have read thoroughly and understand completely all instructions, safety rules, etc. contained in this manual. Failure to comply can result in accidents involving fire, electric shock, or serious personal injury. Save this operator's manual and review frequently for continuing safe operation and instructing others who may use this tool.

BASIC OPERATION

WARNING: Always wear safety goggles or safety glasses with side shields during power tool operation or when blowing dust. If operation is dusty, wear a dust mask.

To be efficient and work as designed, your tools should be kept sharp. Dull tools will cause accidents.

Bench Grinders are ideal for sharpening tools such as chisels, planer blades, scissors, etc., and for removing rust or corrosion. Grinders remove material rapidly so pressure is the key to efficient grinding.

The proper way to sharpen a tool and avoid overheating is:

- Keep the object in constant motion, moving it at an even pace.
- Never force a tool against the grinding wheel.
- Keep the tool cool by using either a cooling tray or a pan of water.
- The grinding wheel should rotate "into" the object being sharpened.

Note: Excessive pressure may damage the tool, cause the motor to overheat, and prematurely wear down the grinding wheel.

The following recommendations will help you sharpen specific tools:

TWIST DRILL BITS

Drill bits are best sharpened on a sharpening jig (available at most hardware stores). Begin on one side of the point at the existing angle, then twist the bit while maintaining contact with the grinding surface. Sharpen only the tip.

This technique requires considerable practice, so take your time and make a few "dry runs" first with the grinder off. Be sure to maintain the original cutting edge angle as this is important to the efficiency of your bits. One work rest has a V-groove angled to fit most drill bits.

LAWN MOWER BLADES

Lawn mower blades are usually sharpened on only one edge and dressed up slightly on the other. Perform this sharpening process on both cutting ends of the blade. After sharpening, be sure to balance the blade by removing additional material.

CAUTION: An unbalanced lawn mower blade may cause excessive vibration which will damage the lawn mower.

CHISELS AND SCREWDRIVER BLADES

When sharpening chisels and screwdrivers, work rest should support the chisel at the correct angle against the wheel.

WARNING: Always disconnect the bench grinder from the power source before performing any assembly or adjustment. Failure to do so could result in accidental starting resulting in possible serious personal injury.

WHEEL REPLACEMENT

If you must replace a grinding wheel, be sure to obtain one with a safe rated speed greater than the “no load speed” RPM marked on the data plate of the grinder and which is marked to comply with ANSI B7.1.

To replace the grinding wheel, remove the wheel cover by loosening the screws. Loosen the wheel nut in a clockwise direction for the left side and a counterclockwise direction for the right side. The wheels do not have a locking mechanism. Hold the wheel in place with one hand while loosen the wheel nut with the other hand. Remove the outer flange and grinding wheel. To install a new grinding wheel, reverse the above procedure. Be sure the grinding wheel and outer flange are properly seated on the spindle shaft.

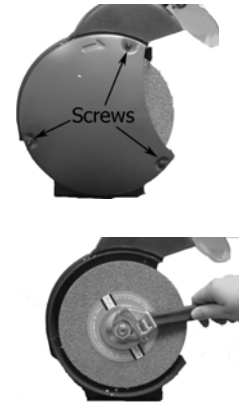

MAINTENANCE

WARNING: When servicing, use only identical replacement parts. Use of any other part may create hazard or cause product damage.

GENERAL

Keep the bench grinder clean. Remove dust from working parts and beneath the grinder frequently.

Make sure the bench grinder operates properly. Check screws, nuts, and bolts for tightness.

NOTE: This bench grinder has been sufficiently lubricated from the factory therefore the bench grinder does not need any additional lubrication during the lifetime of the grinder.

EXTENSION CORDS

The use of any extension cord will cause some loss of power. To keep the loss to a minimum and to prevent tool overheating, use an extension cord that is heavy enough to carry the current the tool will draw.

A wire gage size (A.W.G.) of at least **16** is recommended for an extension cord 25 feet or less in length. When working outdoors, use an extension cord that is suitable for outdoor use. The cord's jacket will be marked WA.

WARNING: Check extension cords before each use. If damaged, replace immediately. Never use tool with a damaged cord since touching the damaged area could cause electrical shock resulting in serious injury.

WORK LIGHT BULB REPLACEMENT

To remove work light bulb, gently push the bulb into the socket and turn counterclockwise. To install the new bulb, gently push the bulb into the socket and turn clockwise.



NOTE: To help prolong the life of the grinding wheel you may want to purchase a WHEEL DRESSER at your local hardware store. WHEEL DRESSER IS NOT INCLUDED.

Dressing a wheel is done to renew sharpness or to true up the face of the wheel.

To use the Wheel Dresser set the work rest of the bench grinder at a slight angle and brace the wheel dresser against it. Do not make contact with the grinding wheel until after you have turned on the motor and the wheel is rotating at full speed. Press the dresser slightly against the rotating wheel until you get a bite, then move slowly from side to side across the wheel. A small bite and many passes is better than a big bite and one pass. Work cautiously; hold the dresser with force on the work rest. Do not use excessive pressure against the grinding wheel. Proceed slowly until you master the technique.

SERVICE CENTER

If you have any question in regards to the operation of this power tool or are in need of a spare part please contact our service center at:

Wachsmuth & Krogmann, Inc.
Tel: 1-888-367-7373
(Business hours Mon-Fri 9:00am - 4:00pm CT)
Website: <http://www.wk-usa.com>

ENVIRONMENTAL PROTECTION



If the tool should no longer work at all, please make sure that it is disposed in an environmentally friendly way, by handing it into a public collection point. Please do not put it with your household waste.

LIMITED WARRANTY

Thank you for purchasing a top quality **KingCraft** product. This **KingCraft 8" Bench Grinder** item #6318-06 was tested and meets our stringent quality standards. This product is warranted to be free from manufacturing defects in original materials, including original parts, and workmanship until **October 8, 2008** or 2 years with proof of purchase. Grinding Wheel and light bulbs included with the Bench Grinder will be limited to 90 day warranty with proof of purchase.

The warranty is void if the defect is due to accidental damage, misuse, abuse, neglect, improper repair or alteration by unauthorized persons or failure to follow operation instructions provided with the product. This warranty does not apply to commercial use.

The warranty is non-transferable and applies only to the original purchase and does not extend to subsequent owners of the product. Liability under this warranty is limited to repair, replacement or refund. In no event shall liability exceed the purchase price paid by the purchaser of the product. Under no circumstances shall there be liability for any loss, direct, indirect, incidental, special or consequential damage arising out of in connection with use of this product. This warranty is valid only in the United States of America. This Warranty gives you specific legal rights. However you may have other rights that vary from state to state. Some states do not allow limitation on implied warranties or exclusion of consequential damages therefore these restrictions may not apply to you.

In case you find the product to be defective please send it within the warranty period to our service center. To avoid transport damages please send the product in the original packaging. In return you will either receive your repaired item, a new product or a refund. Please fill out the Warranty Card and send it together with the product and purchase receipt

To arrange pick-up of the defective item please call our service center:

Wachsmuth & Krogmann Inc.

Tel: 1-888-367-7373 (Business hours Mon-Fri 9:00am-4:00 pm CT)

Website: <http://www.wk-usa.com>

1800 Nicholas Blvd.

Elk Grove Village

IL 60007, USA

WARRANTY INFORMATION

WARRANTY CARD

Kingcraft 8" Bench Grinder, item # 6318-06, model # TBG818

In case you find this product to be defective please send it within the warranty period to our service center. To avoid transport damages please send the product in the original packaging. In return you will receive your repaired item, a new product or a refund. This product is warranted to be free from manufacturing defects in original materials, including original parts, and workmanship until **October 8, 2008** or 2 years with proof of purchase. Grinding Wheel and light bulbs included with the Bench Grinder will be limited to 90 day warranty with proof of purchase.

Please fill in your details below and send it together with the product and purchase receipt. Please read the Limited Warranty conditions mentioned in this instruction manual.

Customer Name	
Street	
City	
State	
ZIP Code	
Purchase Date	
Description of Defect :	

To arrange pick-up of the defective item please call our service center:

Wachsmuth & Krogmann Inc.
Tel: 1-888-367-7373 (Business hours Mon-Fri 9:00am-4:00 pm CT)
Website: <http://www.wk-usa.com>
1800 Nicholas Blvd.
Elk Grove Village
IL 60007, USA

PLEASE DETACH THIS SECTION AND RETURN IT WITH YOUR PRODUCT



WARRANTY CARD